

# SKI-DOO KIT - tMotion Rigid Arm

Part number (SKU) : 860202413

Product:	<b>Ski-Doo</b>
Project no:	<b>487803830</b>
Instruction Sheet P/N:	<b>487803830</b>
Revision no:	
Revision date:	
Item covered:	<b>tMotion Rigid Arm</b>

The following symbols may be used in this document:

## WARNING

Indicates a hazardous situation which, if not avoided, could result in death or serious injury.

**CAUTION:** Indicates a hazard situation which, if not avoided, could result in minor or moderate injury.

**NOTICE** Indicates an instruction which, if not followed, could severely damage vehicle components or other property.

## WARNING

- This kit is designed for specific applicable models only (authorized BRP dealers will confirm model(s)). It is not recommended for units other than the one (those) for which it was sold.
- Should removal of a locking device (e.g. lock tabs, self-locking fasteners, etc.) be required when undergoing disassembly/assembly, always replace with a new one.
- Torque wrench tightening specifications must strictly be adhered to.
- Unless otherwise specified, engine must be OFF when performing any operation on the vehicle.
- Always be aware of parts that can move, such as wheels, transmission components, etc.

## WARNING

Some important safety information and/or operating instructions dedicated to the end user might be included in this instruction sheet. Make sure to give the kit part number as well as the instruction sheet included with this kit to the customer. Verify that the customer has access to all the information required for proper use of the accessory.

**NOTE:** USE TIGHTENING TORQUES IN THE FOLLOWING TABLE IF NOT OTHERWISE SPECIFIED.



	GRADE			
	5.8	8.8	10.9	12.9
M4	1.8 ± 0.2 N•m (16 ± 2 lbf•in)	2.8 ± 0.2 N•m (25 ± 2 lbf•in)	3.8 ± 0.2 N•m (34 ± 2 lbf•in)	4.5 ± 0.5 N•m (40 ± 4 lbf•in)
M5	3.3 ± 0.2 N•m (29 ± 2 lbf•in)	5 ± 0.5 N•m (44 ± 4 lbf•in)	7.8 ± 0.7 N•m (69 ± 6 lbf•in)	9 ± 1 N•m (80 ± 9 lbf•in)
M6	7.5 ± 1 N•m (66 ± 9)	10 ± 2 N•m (89)	12.8 ± 2.2 N•m (113)	16 ± 2 N•m (142)

	lbf•in)	± 18 lbf•in)	± 19 lbf•in)	± 18 lbf•in)
M8	15.3 ± 1.7 N•m (135 ± 15 lbf•in)	24.5 ± 3.5 N•m (18 ± 3 lbf•ft)	31.5 ± 3.5 N•m (23 ± 3 lbf•ft)	40 ± 5 N•m (30 ± 4 lbf•ft)
M10	29 ± 3 N•m (21 ± 2 lbf•ft)	48 ± 6 N•m (35 ± 4 lbf•ft)	61 ± 9 N•m (45 ± 7 lbf•ft)	73 ± 7 N•m (54 ± 5 lbf•ft)
M12	52 ± 6 N•m (38 ± 4 lbf•ft)	85 ± 10 N•m (63 ± 7 lbf•ft)	105 ± 15 N•m (77 ± 11 lbf•ft)	128 ± 17 N•m (94 ± 13 lbf•ft)
M14	85 ± 10 N•m (63 ± 7 lbf•ft)	135 ± 15 N•m (100 ± 11 lbf•ft)	170 ± 20 N•m (125 ± 15 lbf•ft)	200 ± 25 N•m (148 ± 18 lbf•ft)
M16	126 ± 14 N•m (93 ± 10 lbf•ft)	205 ± 25 N•m (151 ± 18 lbf•ft)	255 ± 30 N•m (188 ± 22 lbf•ft)	305 ± 35 N•m (225 ± 26 lbf•ft)
M18	170 ± 20 N•m (125 ± 15 lbf•ft)	273 ± 32 N•m (201 ± 24 lbf•ft)	330 ± 25 N•m (243 ± 18 lbf•ft)	413 ± 47 N•m (305 ± 35 lbf•ft)

**NOTE:** The illustrations in this document show typical construction of the different assemblies and may not reproduce the full detail or exact shape of the parts; however, they represent parts that have the same or similar function.

Installation time is approximately **0.5** hours.

**ICON LEGEND**

ICON	INDICATE
	Parts to be discarded
	Parts kept for reinstallation

**PARTS TO BE INSTALLED**

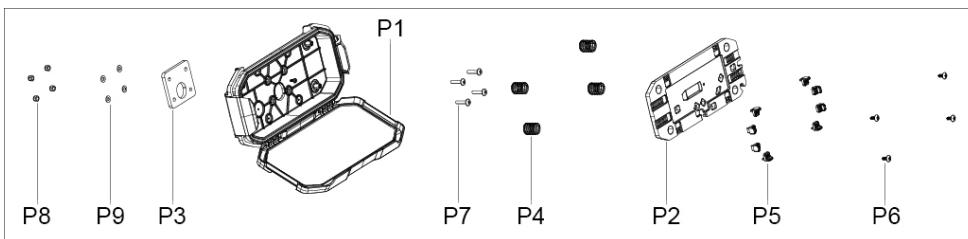

ITEM	DESCRIPTION	PART NUMBER	QTY
P1	tMotion rigid arm	Not sold separately	1
P2	M8 Elastic nut	233281466	5
P3	M6 Elastic nut	233261416	2

## VEHICLE PREPARATION

Remove and discard both (2) original M8 elastic nuts.

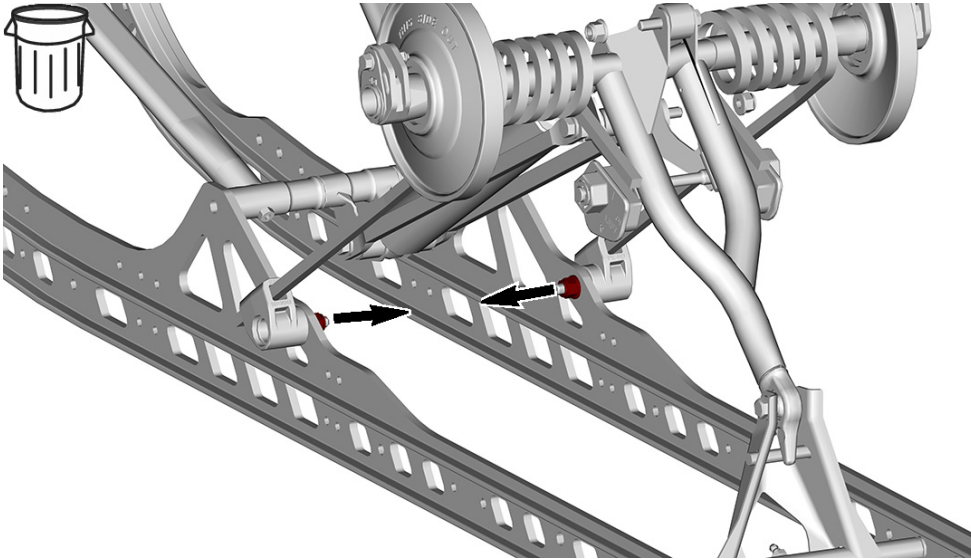

Remove and keep screw and spring support.

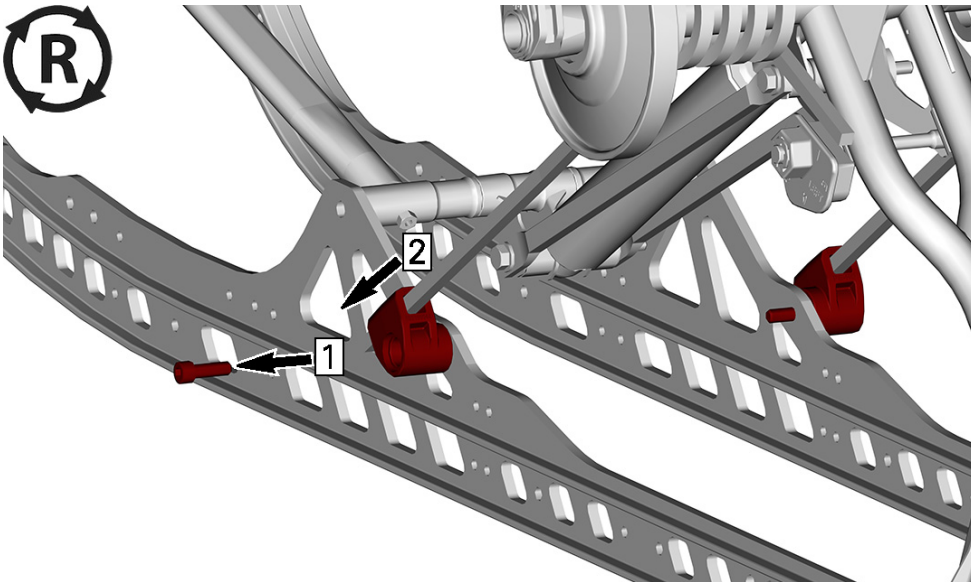

Remove and discard original M6 elastic nut.

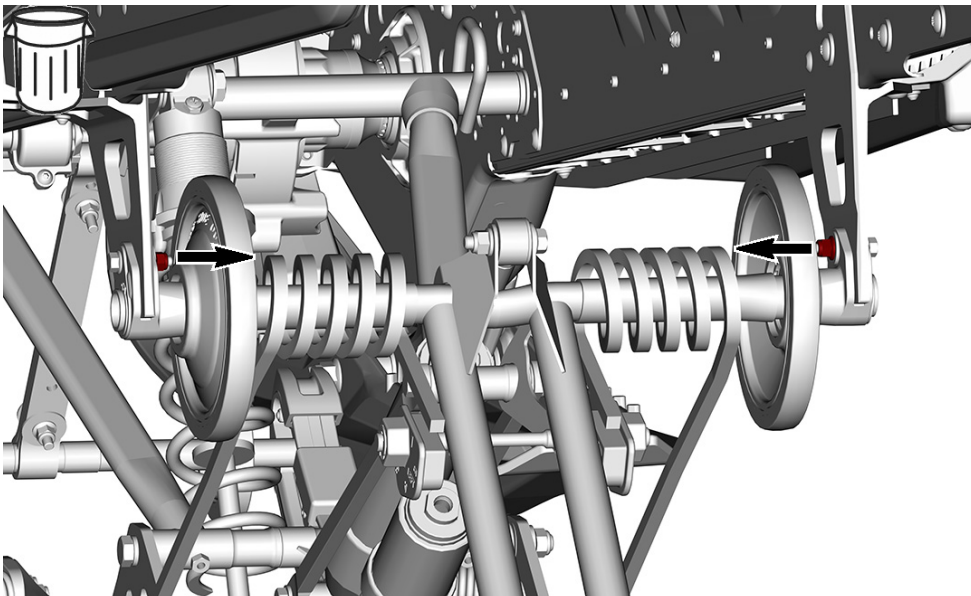

Remove and keep wheel suspension assembly.

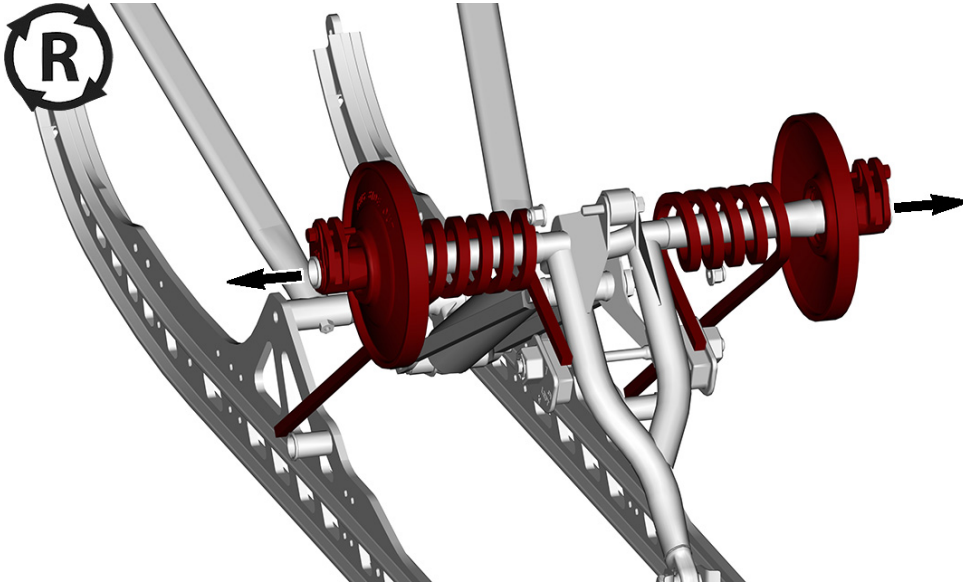

Remove and discard original M8 elastic nut.

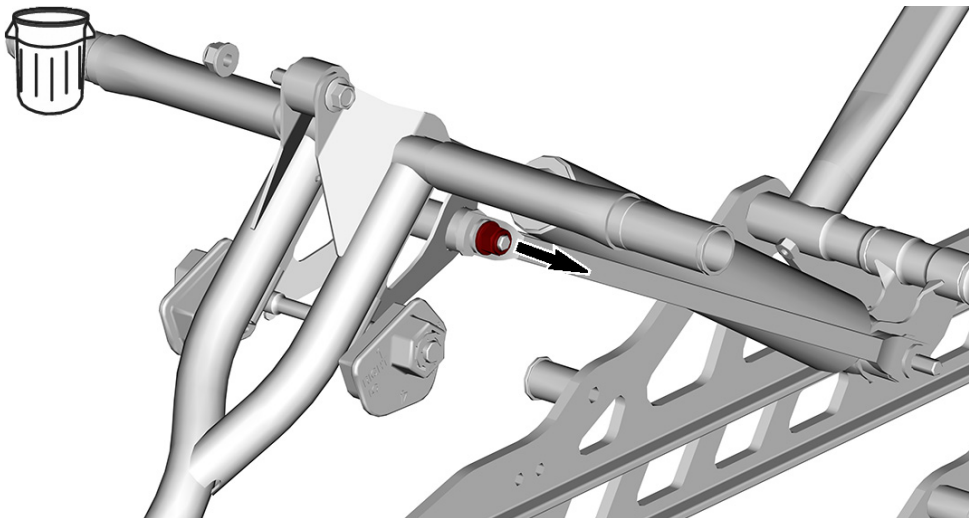

Remove and keep screw and washer.

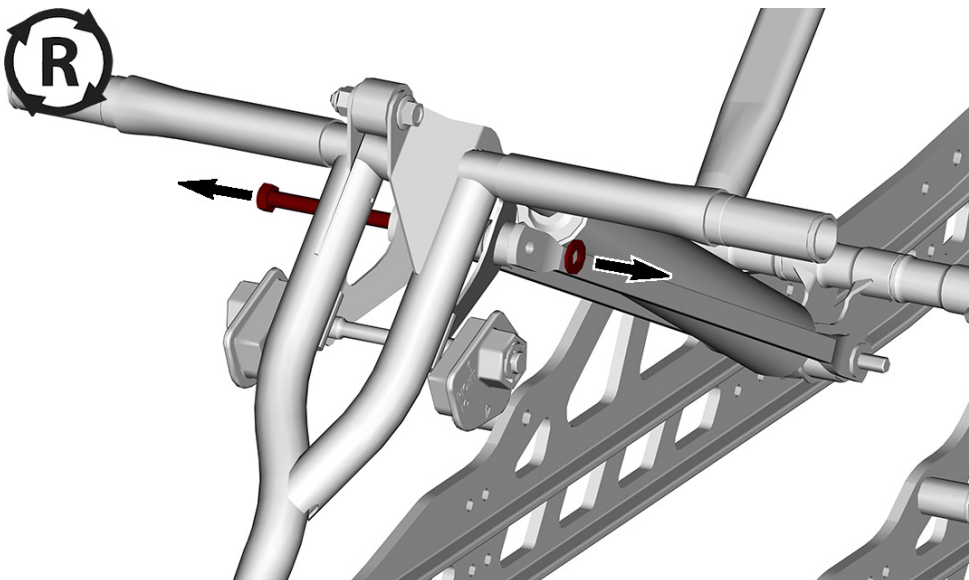

Remove and discard original M8 elastic nut.

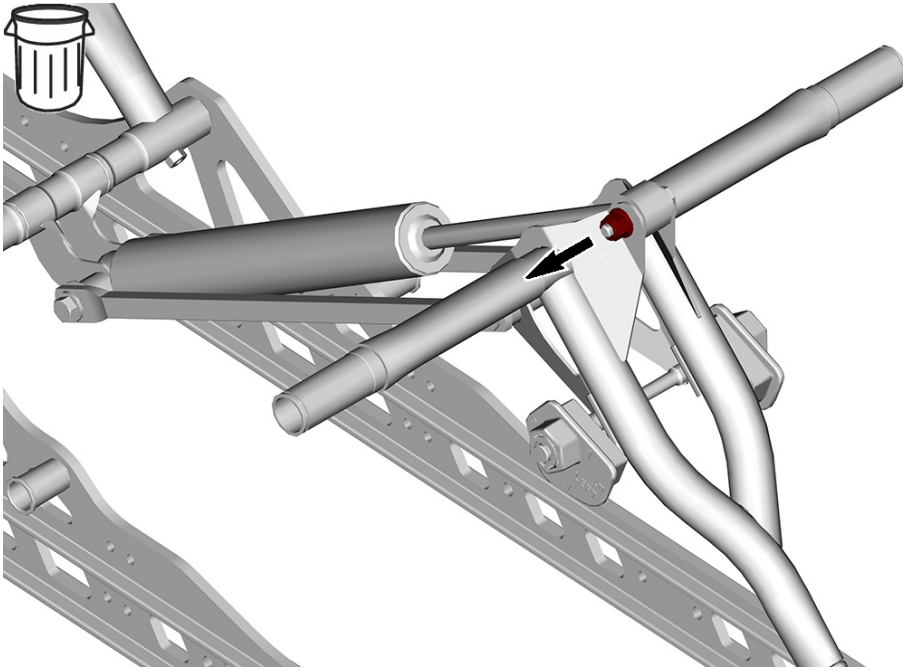

Remove and keep screw.

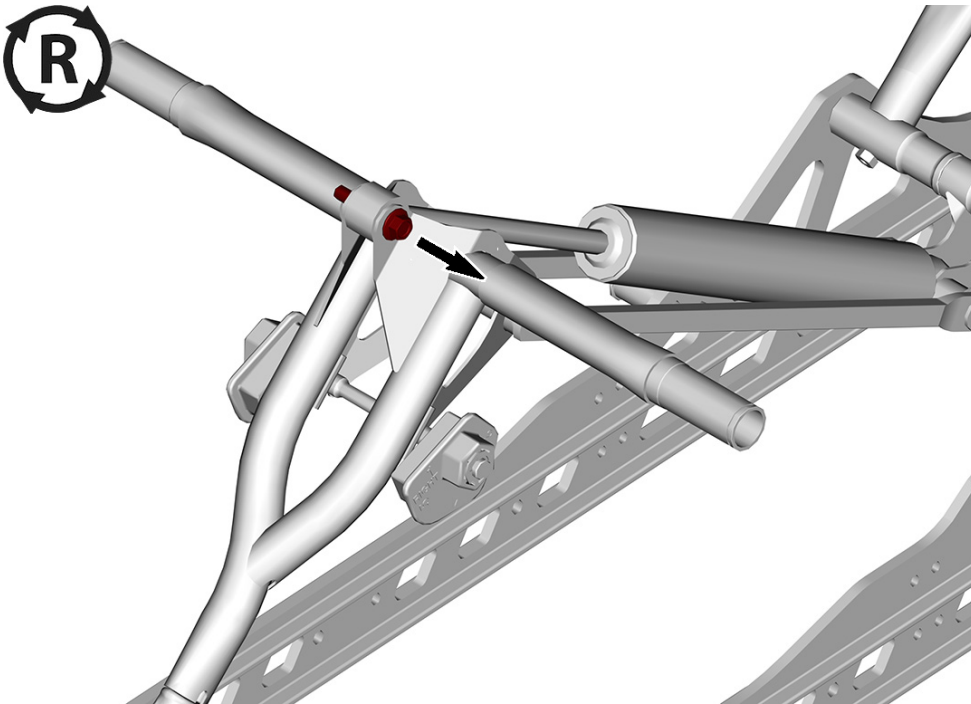

Remove and discard original M8 elastic nut.

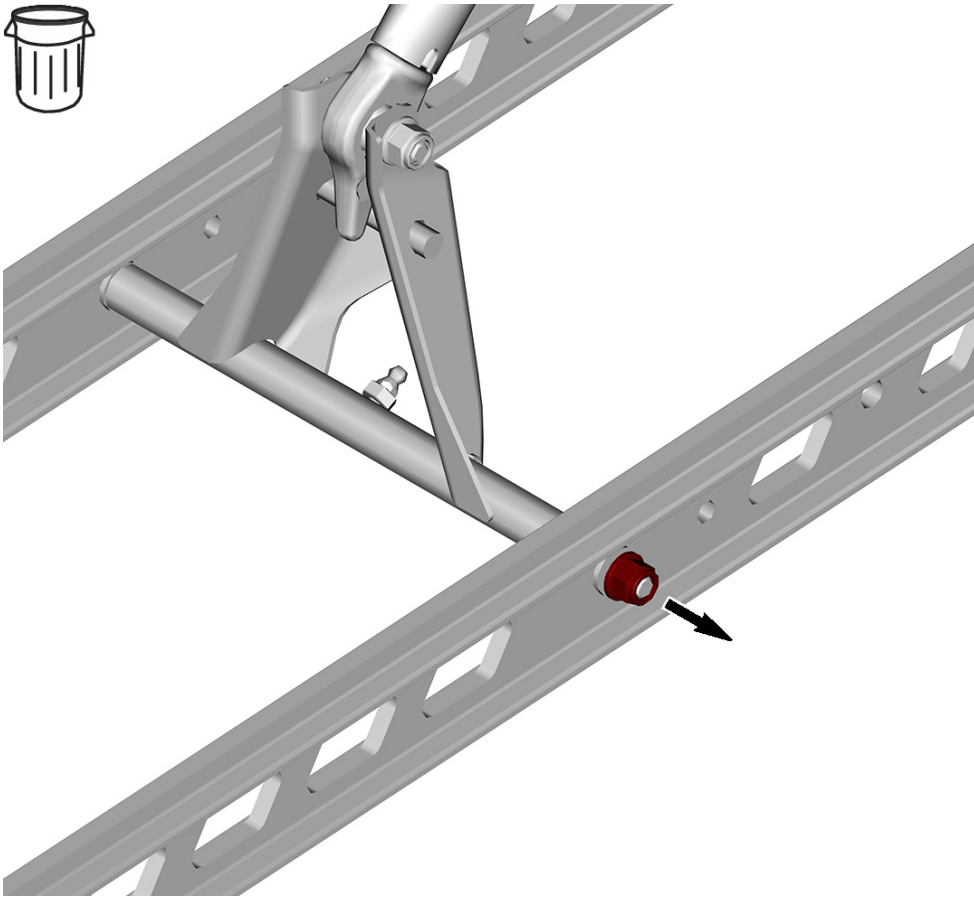

Remove original tMotion arm. Keep for reuse.

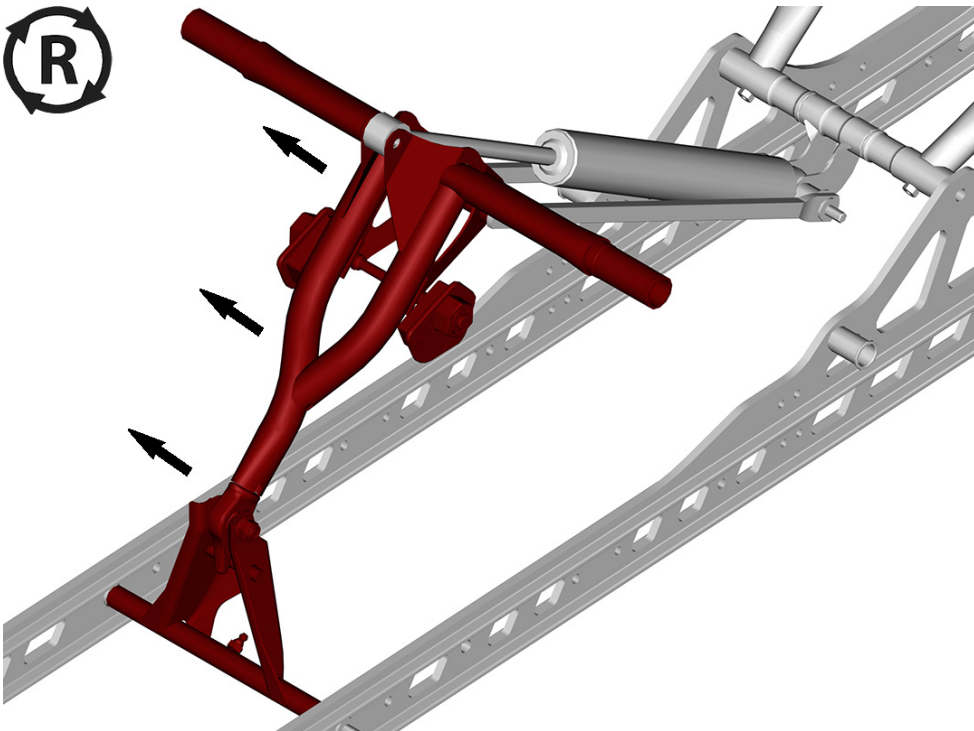

Remove and keep both (2) tubes and the long screw.

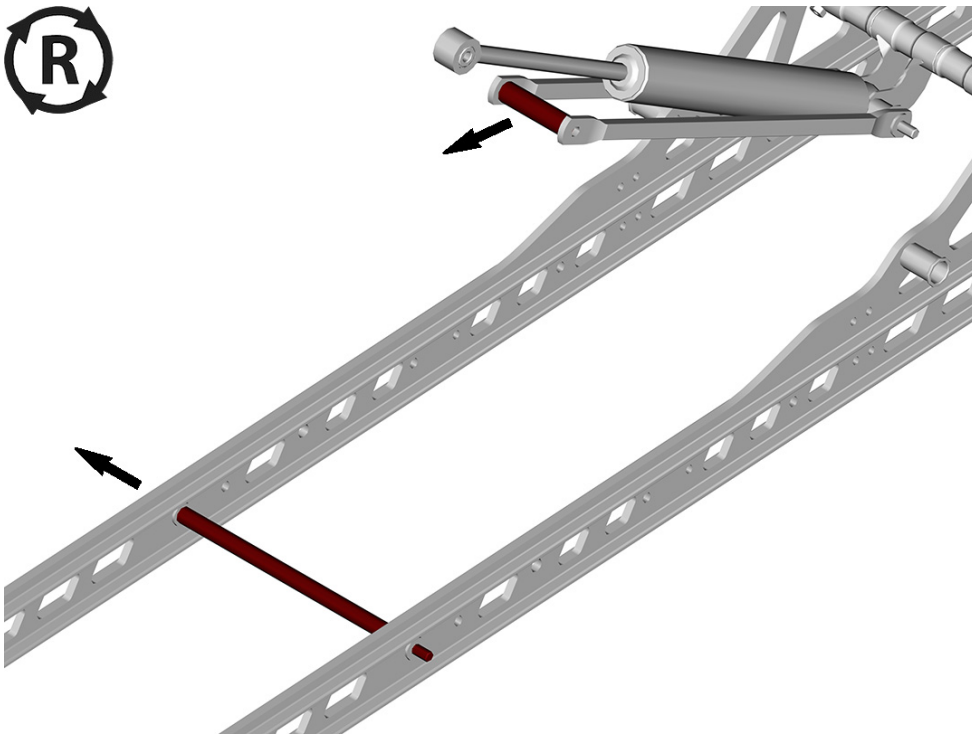

## PARTS PREPARATION

Install both (2) tubes and long screw in the tmotion arm as shown.

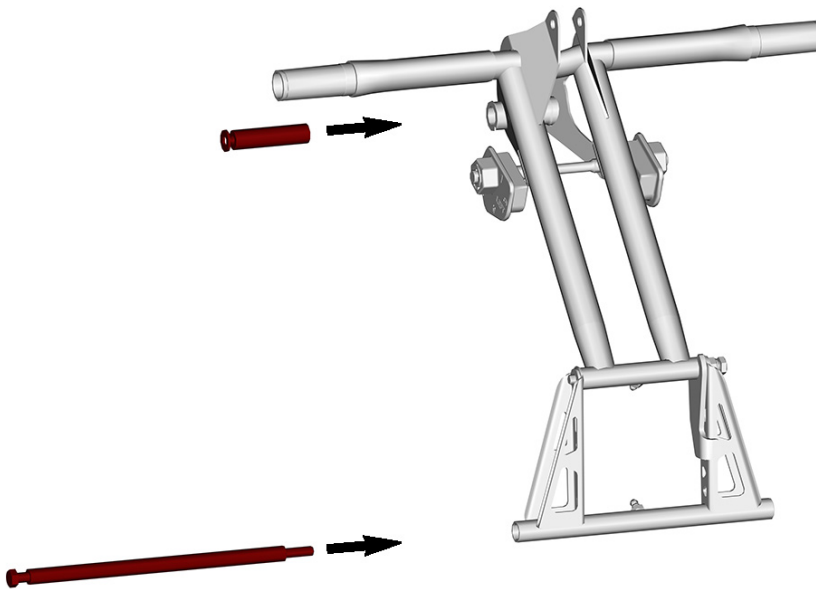

## INSTALLATION INSTRUCTIONS

Install the tMotion rigid arm [P1] and screw the M8 elastic nuts [P3] as shown.

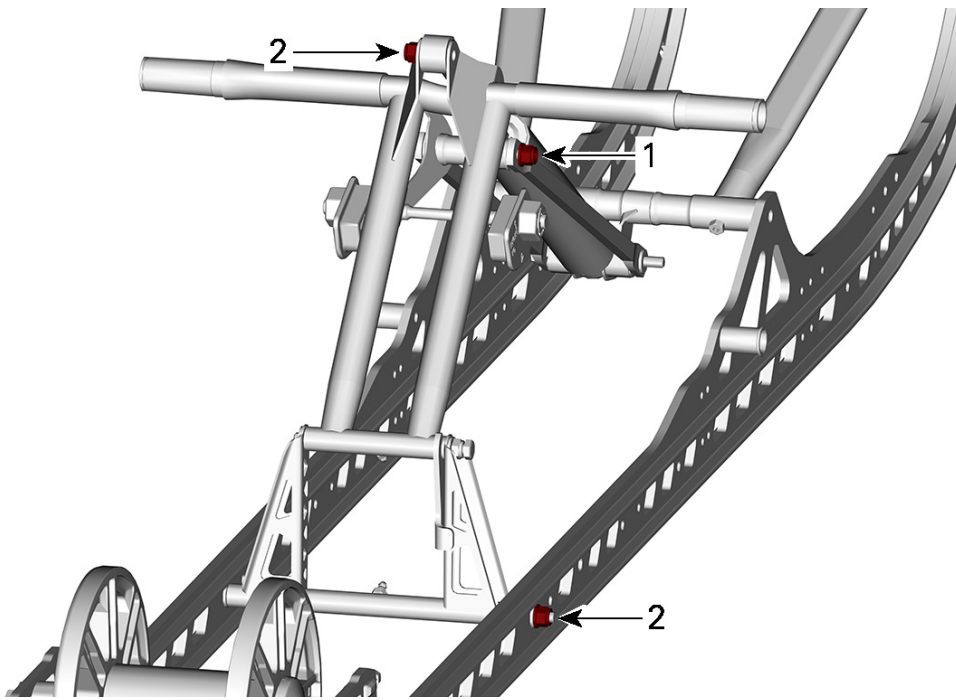

TIGHTENING TORQUE	
M8 elastic nut [P2] - Position 1	35 ± 3 N•m (26 ± 2 lbf•ft)

TIGHTENING TORQUE	
M8 elastic nut [P2] - Position 2	24.5 ± 3.5 N•m (18 ± 2.5 lbf•ft)

Reinstall wheel suspension assembly, spring support and its respective screw.

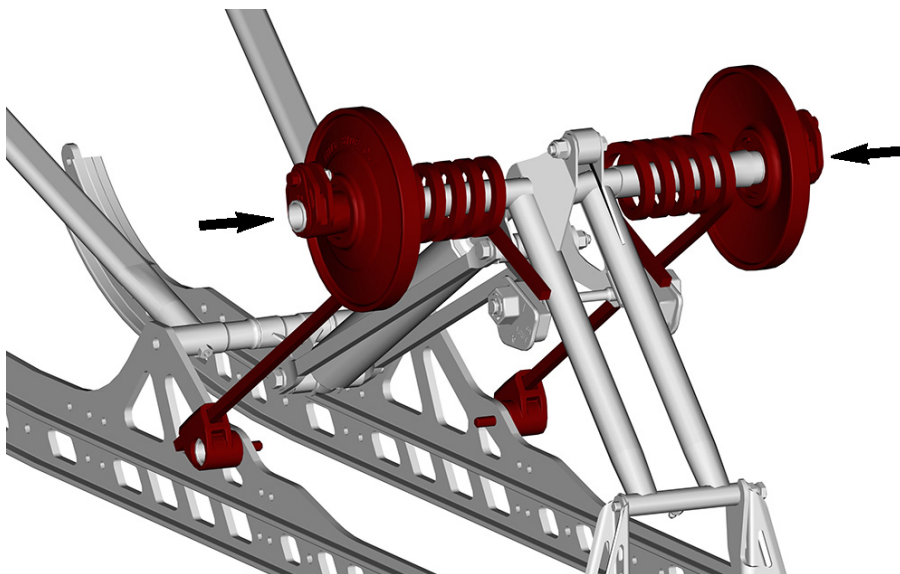

Screw both (2) M6 elastic nuts [P3].



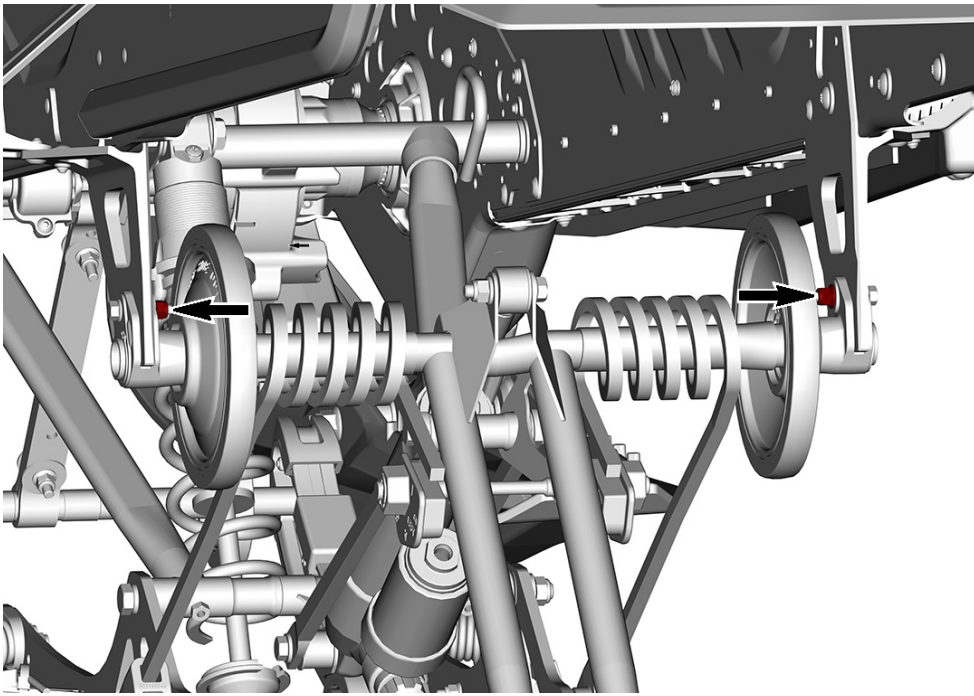

TIGHTENING TORQUE	
M6 elastic nut [P3]	15 ± 2 N•m (133 ± 18 lbf•in)

Screw two (2) M8 elastic nuts [P2].

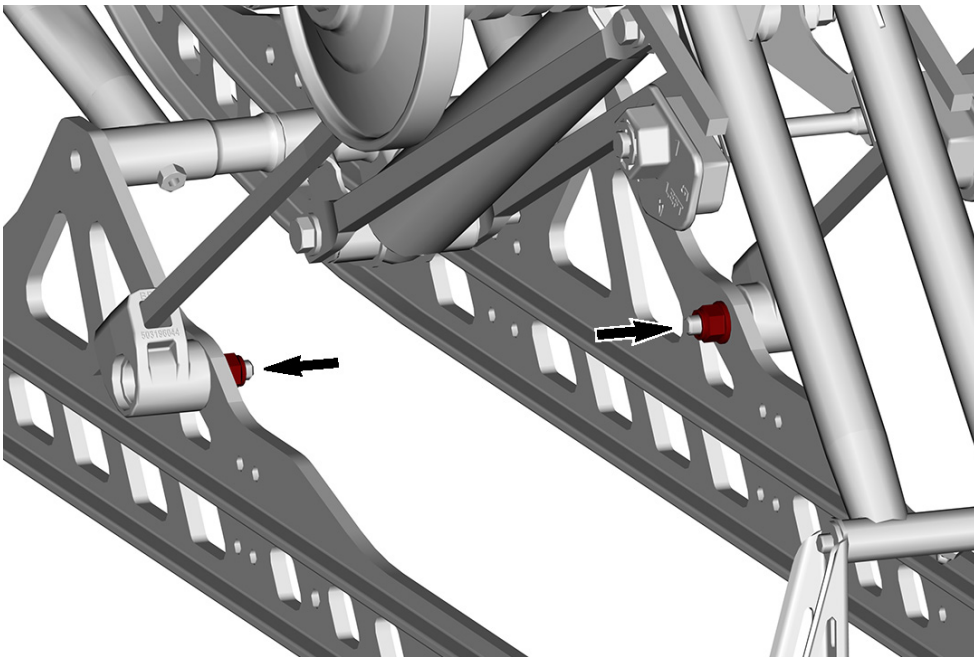

TIGHTENING TORQUE	
M8 elastic nut [P2]	24.5 ± 3.5 N•m (18 ± 3 lbf•ft)